

BERGER ENGINEERING AND SURVEYING

100 Fulton Avenue
Poughkeepsie, New York 12603
Engineering Services: (845) 471-7383
GIS Services: (845) 392-7180
www.BergerEngr.com

STORMWATER POLLUTION PREVENTION PLANS

Storm water runoff is simply rain water or snow melt that runs off the land and into streams, rivers, and lakes. When storm water runs through sites of industrial activity it may pick up pollutants and transport them into national waterways and effect commercial fisheries, restrict swimming areas, and affect the navigability of the nation's waters.

To help curb the problem of storm water runoff pollution the EPA (Environmental Protection Agency) has developed a program under the Clean Water Act. A major part of this program is the NPDES (National Pollution Discharge Elimination System) which requires industrial activities to register for a discharge permit. Many industrial activities can apply under a general permit. To find out if you can register under a general permit, contact your area office.

In New York the DEC (Department of Environmental Conservation) issues discharge permits under the SPDES (State Pollutant Discharge Elimination System) program. In New York, industrial activities must submit an NOI (Notice of Intent) to determine whether they are eligible for a general permit.



Berger Engineering and Surveying, PLLC

has been preparing SWPPP'S since the 1995 and will help you through the process of evaluating your site and determining the best plan for treatment of Stormwater and erosion control. We will also provide construction supervision and inspection as needed.



A typical SWPPP includes:

- **NOI and authorization**
- **Site Map**
- **Typical Installation Details**
- **Reporting Forms**
- **Copy of the Permit**
- **Soils Information**
- **Rainfall Erosivity**

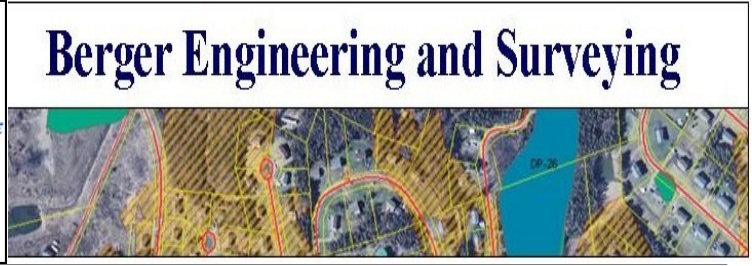
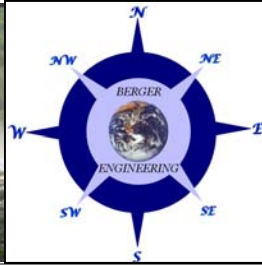

TYPICAL PROJECTS

Brookside Meadows Town of Pleasant Valley Dutchess County New York

Site Engineer during construction responsible for weekly SWPPP Inspections and modifications in SWPP to fit site. Project consists of 302 residential units in a two phase project off of West Road in Pleasant Valley. Project consisted of several infiltration basins and grass swales as method of storm water treatment. The project has a stream flowing through the site as well as wetlands.



Oakwood Commons Town of Poughkeepsie Dutchess County New York

Site Engineer during construction. Responsible for weekly SWPPP inspections and modifications in SWPPP to fit site conditions. Also responsible for inspection and certification of water mains, sanitary sewers and storm sewer collection, detention and treatment systems. Project consists of two 5 story office buildings, a restaurant, drug store, hotel and parking garage. Storm detention was accomplished with underground stormwater storage and treatment was accomplished with two sand filters.

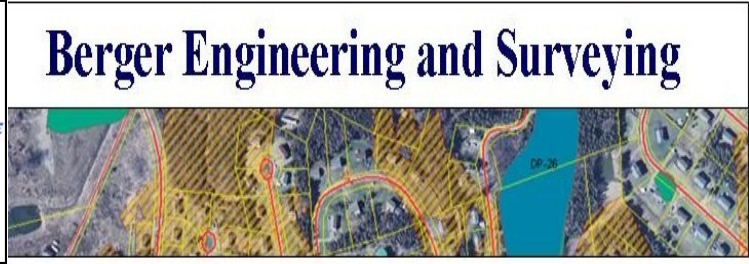
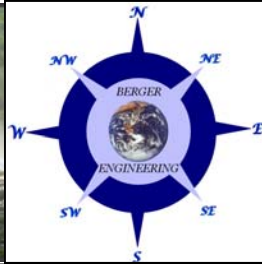

FLOOD PLAINS AND STORM WATER WATERSHED MAPPING

In addition to assisting with stormwater and MS4 regulations, Berger Engineering and Surveying, PLLC and Kendall Stormwater Services, LLC can assist you in management of flood plain issue such as determine performing flood studies, determination of flood plain elevations , preparation of Letter of Map Amendments (LOMA) of Letter of Map Revision (LOMR).

Compliance with MS4 requirements and determination of flood plain elevations often requires mapping of stormwater structures , location of illicit discharge locations and general mapping of the watershed.

Berger Engineering and Surveying uses both GPS and standard surveying practices using total stations and automatic levels to survey and establish the location of the base flood elevation (BFE) and will assist you by completing the elevation certificate or provide engineering services to complete the LOMA or LOMR process. This process is best described on the following web site:

http://www.floodmaps.fema.gov/archive/fmc_loma.shtm

Town of Hyde Park

HYDE PARK MS4 REGULATED OUTFALLS INSPECTED BY BERGER ENGINEERING AND SURVEYING

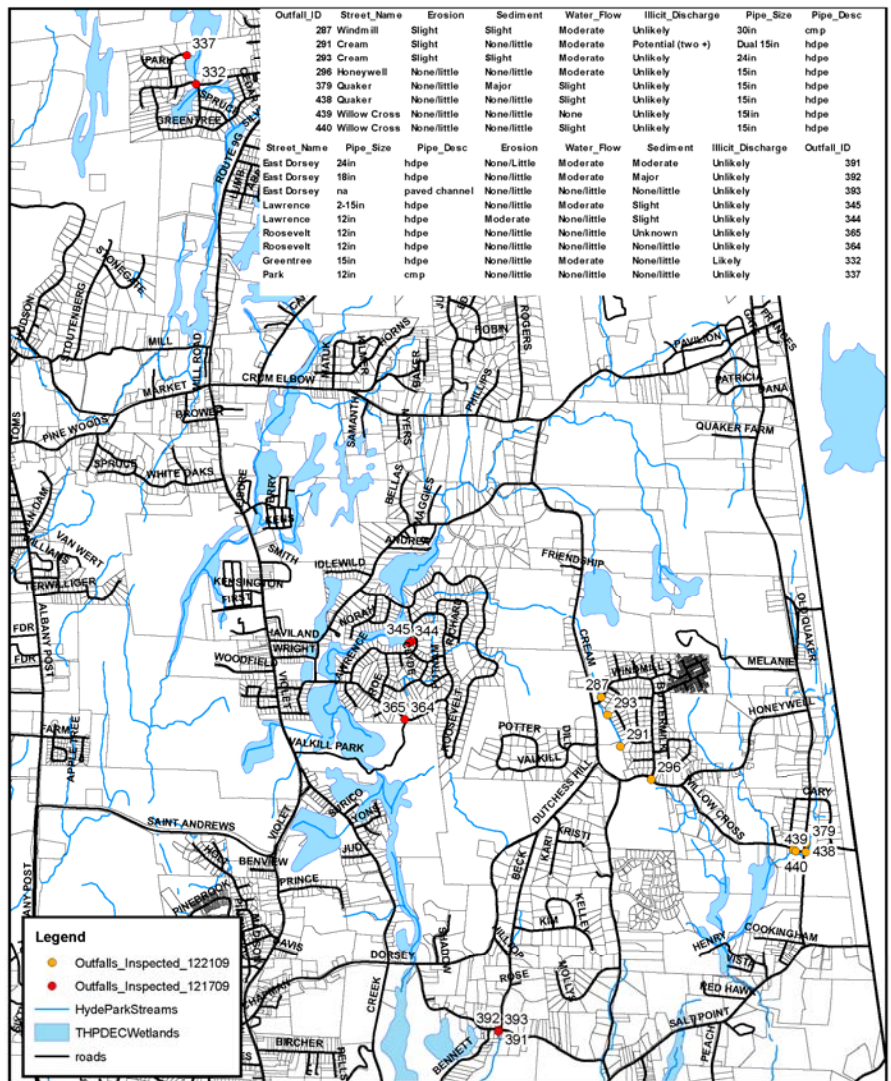

Map Created 12/21/09

Berger Engineering and Surveying
100 Fulton Avenue
Poughkeepsie, New York 12603
www.BergerEngr.com

